

**ART. 401** VITI TESTA ESAGONALE PARZIALMENTE FILETTATE  
DIN 931 - UNI 5737 - ISO 4014

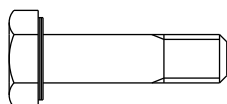

L \ D	M5	M6	M8	M10	M12	M14	M16	M18	M20	M22	M24	M27	M30
25	8,49	8,02											
30	8,01	7,51	15,84										
35	8,81	8,48	15,84	29,05									
40	9,61	9,40	17,27	29,05	43,58								
45	11,21	10,32	18,85	30,65	43,58	80,71	83,57						
50	12,81	11,14	19,64	32,13	44,44	82,49	90,26						
55	16,01	12,97	22,12	35,60	48,63	85,51	90,46						
60	16,01	13,79	22,98	37,70	51,18	90,15	93,37	181,64	181,64				
65		16,49	25,97	39,59	54,14	96,13	104,00	175,20	175,20				
70		17,36	28,10	42,04	57,82	101,55	106,14	181,84	181,84	480,30	561,96		
75		22,41	30,83	45,21	61,09	108,19	114,93	196,27	196,27		561,96		
80		24,02	34,22	49,14	67,94	113,40	120,45	204,32	204,32	480,30	427,64	816,52	1084,56
90		28,82	40,10	53,33	75,85	130,76	143,02	224,75	224,75	528,34	464,83	816,52	1104,70
100		33,62	46,24	65,08	82,75	148,08	155,38	246,20	246,20	576,37	527,90	880,56	1184,75
110		38,42	56,04	81,78	92,81	150,17	173,16	261,94	261,94	640,41	531,90	944,60	1264,80
120		51,23	62,44	92,86	107,27	168,05	181,33	294,73	294,73	688,44	595,63	992,63	1344,85
130		57,64	68,84	112,07	140,89	208,13	185,93	352,22	314,14	736,47	619,54	1040,66	1408,89
140		59,24	77,47	128,08	152,10	224,14	225,77	384,24	353,98	800,51	658,72	1088,69	1488,95
150		64,04	84,85	144,09	168,11	248,16	244,16	416,26	384,12	880,56	721,15	1136,72	1552,99
160			137,72	176,11	200,13	482,03	278,90	480,30	441,84	1040,66	779,58	1248,79	1713,09
170			149,77	197,98	240,15	636,96	357,56		526,12		943,61	1520,97	1793,14
180			175,60	227,24	256,16	688,61	381,57	929,62	583,84	1232,78	998,71	1601,02	1857,18
200			222,08	278,89	320,20	800,51	432,14	981,27	645,65	1344,85	1176,02	1687,09	1969,25

Prezzo in Euro per 100 pezzi  
per viteria A2

**ART. 402** VITI TESTA ESAGONALE INTERAMENTE FILETTATE  
DIN 933 - UNI 5739 - ISO 4017

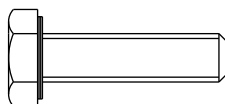

L \ D	M3	M4	M5	M6	M8	M10	M12	M14	M16	M18	M20	M22	M24	M27	M30
6	4,13	4,13													
8	4,13	4,13	4,82	5,85											
10	4,13	4,13	4,01	5,01	11,36	24,96									
12	4,13	4,12	3,89	4,81	10,02	24,10									
14	4,48	4,58	4,47	4,99	11,86	22,38									
16	4,48	4,65	4,22	4,73	9,20	18,41	36,15								
18	4,82	5,34	4,86	5,76	10,56	19,84									
20	4,82	5,00	4,70	5,22	9,97	18,71	31,14	65,34	79,19						
22	5,16	5,85	5,68	6,70	12,17	19,99									
25	5,68	5,68	5,18	6,00	11,07	19,63	29,81	64,93	64,93		189,37				
30	6,20	6,37	5,94	6,95	12,48	20,86	30,96	61,20	66,31	122,86	150,83				
35		7,34	6,46	7,86	13,75	23,47	33,54	64,22	64,96	129,77	127,31				
40		8,81	7,36	8,69	15,19	24,24	35,84	68,77	70,00	129,77	131,71	336,21	294,45		
45		11,19	9,61	9,51	16,69	27,71	39,32	74,04	74,29	133,65	136,31	336,21	303,76		
50		12,05	11,21	10,30	18,66	29,50	41,01	78,64	77,46	139,68	140,61	352,22	309,74	624,40	
55			13,61	14,57	20,55	32,98	47,93	83,39	84,72	145,77	153,64	400,25	345,63		
60			13,61	15,44	21,27	35,79	50,77	89,07	89,63	154,05	157,22	400,25	343,64	680,43	880,56
65				20,01	24,12	40,90	55,73	96,02	97,15	161,77	171,44	432,27	366,90		
70				22,09	29,15	44,48	59,97	100,06	104,97	167,86	178,95	432,27	381,52	736,47	944,60
75				24,79	32,02	50,10	69,72	111,04	113,62		196,25				
80				25,62	33,62	52,31	74,34	116,57	119,23	193,42	207,07	464,29	428,71	784,50	1008,64
90				30,42	44,83	67,24	86,45	163,54	144,09	292,66	232,15	528,34	512,33	848,54	1072,68
100				36,82	52,83	75,25	96,06	172,15	160,10	320,20	248,16	592,38	560,36	896,57	1136,72
110				48,20	64,04	92,86	128,08	208,13	192,12	384,24	296,19	640,41	624,40	1040,66	1360,86
120				55,09	72,05	112,07	144,09	232,15	216,14	448,28	336,21	704,45	688,44	1104,70	1440,91

Prezzo in Euro per 100 pezzi

NOTA: le zone evidenziate rappresentano la gamma di materiale reperibile presso il produttore

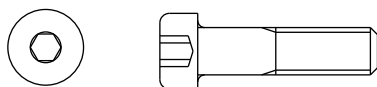
**ART. 403** VITI TESTA CILINDRICA CON CAVA ESAGONALE  
 DIN 912 - UNI 5931 - ISO 4762

L \ D	M3	M4	M5	M6	M8	M10	M12	M14	M16	M20	M24
6	5,12	5,12	8,01								
8	4,80	4,38	5,60	8,01							
10	4,48	4,03	4,33	6,80	14,09						
12	4,16	3,79	4,28	5,32	12,16						
14	4,80	4,28	5,02	7,53	15,34						
16	4,48	4,17	4,33	5,60	11,35	27,52					
18	5,44	4,58	5,47	7,76	13,65	25,65					
20	5,12	4,26	4,74	6,49	12,97	20,78	32,13		112,07		
22	6,08	5,19	6,03	8,52	15,02	24,96					
25	5,76	5,05	5,88	7,03	13,23	21,90	31,12	100,86	104,91		
30	6,72	5,67	7,03	7,87	14,69	23,73	33,78	100,86	100,06	256,16	
35	8,01	6,53	8,13	9,48	16,31	25,95	36,83	105,67	100,06	256,16	
40	8,81	7,16	8,95	10,36	18,71	27,07	40,23	112,07	103,74	256,16	800,51
45		10,33	10,74	12,06	22,21	30,74	42,35	120,08	113,79	271,14	800,51
50		11,88	13,11	13,78	23,83	34,08	45,84	126,48	116,30	280,18	800,51
55			16,11	15,93	25,50	39,00	51,50	136,09	128,02	304,19	
60			17,51	17,04	28,01	42,27	55,83	144,09	135,41	320,20	896,57
65			25,31	22,72	32,02	47,98	60,76	160,10	148,20	352,22	
70			27,22	24,28	33,83	51,45	68,84	168,11	159,04	368,23	1088,69
80			32,02	30,99	44,66	61,05	82,43	192,12	187,20	448,28	1200,76
90				33,62	53,42	74,89	95,52	224,14	219,37	480,30	1344,85
100				44,83	59,08	86,70	107,78	256,16	245,70	512,33	1472,94
110				56,04	88,06	128,08	152,10	288,18	288,18	608,39	1681,07
120				64,04	100,86	144,09	168,11	312,20	312,20	672,43	1761,12
130				72,05	112,07	160,10	200,13	344,22	344,22	768,49	2001,27
150				104,07	134,49	192,12	248,16	400,25	400,25	960,61	2321,47

Prezzo in Euro per 100 pezzi

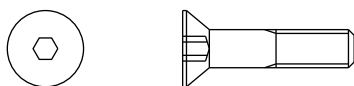
**ART. 404** VITI TESTA PIANA SVASATA CON CAVA ESAGONALE  
 DIN 7991 - UNI 5933

L \ D	M3	M4	M5	M6	M8	M10	M12	M16	M20
6	4,80	4,80	8,01						
8	4,48	4,48	5,76	6,40					
10	4,00	4,00	4,48	6,03	12,91				
12	3,84	3,84	4,48	5,28	10,41				
14	4,16	4,16	5,28	6,40	13,61				
16	3,84	3,84	4,48	5,44	10,41	27,54			
18	5,12	5,12	5,60	6,88	13,61	30,99			
20	4,48	4,48	4,96	6,08	11,53	20,81	43,23		
22	5,68	5,68	6,20	8,01	14,41				
25	5,44	5,44	5,76	6,88	12,17	22,41	46,43	192,12	
30	6,40	6,40	6,72	8,01	13,77	24,82	51,23	160,10	
35	7,20	7,20	8,17	9,13	16,01	27,70	54,43	168,11	
40	8,49	8,49	9,29	10,57	18,25	29,62	59,24	176,11	352,22
45		10,41	12,01	12,49	20,49	33,62	64,04	184,12	368,23
50		11,53	13,61	13,61	23,21	36,82	67,24	200,13	384,24
55			19,11	15,69	25,62	41,63	75,75		
60			20,01	17,90	28,18	44,03	88,06	216,14	416,26
65			27,37	23,76	35,64	59,24	108,46		
70			28,82	25,31	38,42	57,64	112,07	256,16	480,30
80			43,23	33,62	49,63	80,05	132,88	272,17	560,36
90				40,03	59,24	96,06	140,89	296,19	608,39
100				48,03	64,04	112,07	147,29	320,20	656,42
120				88,77	136,09	241,01	288,18		

Prezzo in Euro per 100 pezzi

NOTA: le zone evidenziate rappresentano la gamma di materiale reperibile presso il produttore

**ART. 405** VITI TESTA CILINDRICA  
TAGLIO CACCIAVITE  
DIN 84 - UNI 6107 - ISO 1207

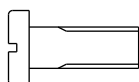

L \ D	M2	M2,5	M3	M4	M5	M6	M8	M10
3	5,16	5,16						
4	2,29	2,40	2,84					
5	2,07	2,18	1,40	2,47				
6	2,07	2,18	1,36	2,40	5,68			
8	2,03	2,18	1,48	2,51	4,38	5,30		
10	2,21	2,36	1,55	2,55	4,18	5,22	14,77	
12	2,21	2,36	1,70	2,69	4,45	5,47	14,77	
14	2,40	2,43	1,88	3,02	5,00	6,11	16,35	
16	2,40	2,51	1,88	3,02	5,00	6,11	16,35	42,87
20	2,77	2,88	2,18	3,36	5,54	6,87	16,35	38,73
25		3,98	2,55	3,87	6,43	7,76	19,52	42,87
30			2,88	4,39	7,09	8,61	23,74	44,93
35			4,02	4,80	8,37	9,46	31,12	49,58
40			5,50	5,87	9,10	10,48	33,23	55,78
45			7,30	7,64	10,23	14,00	36,93	67,14
50			8,63	8,96	11,08	17,73	40,09	70,75
60				13,91	15,34	21,93	50,64	91,93
70					26,42	34,07	62,34	113,10
80					35,79	43,87	84,40	134,28
90						70,00	109,20	158,55
100						93,33	129,48	176,63

Prezzo in Euro per 100 pezzi

**ART. 406** VITI TESTA PIANA SVASATA  
TAGLIO CACCIAVITE  
DIN 963 - UNI 6109 - ISO 2009

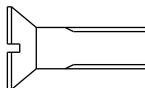

**ART. 409** VITI TESTA PIANA SVASATA  
CON CALOTTA  
TAGLIO CACCIAVITE  
DIN 964 - UNI 6110 - ISO 2010

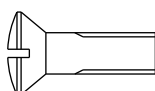

**ART. 407** VITI A METALLO  
TESTA CILINDRICA  
TAGLIO CROCE  
DIN 7985 - UNI 7687 - ISO 7045

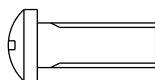

L \ D	M2	M2,5	M3	M4	M5	M6	M8
3	5,16	5,16					
4	2,29	2,40	2,69				
5	2,07	2,18	1,48	2,58			
6	2,07	2,18	1,40	2,40	5,68		
8	2,03	2,18	1,36	2,18	4,26	5,98	
10	2,21	2,36	1,44	2,32	4,14	6,02	15,91
12	2,21	2,36	1,59	2,43	4,49	6,15	15,91
14	2,40	2,43	1,73	2,77	4,92	6,79	17,61
16	2,40	2,51	1,73	2,77	4,92	6,79	17,61
20	2,77	2,88	1,96	3,06	5,42	7,34	17,61
25		3,98	2,32	3,43	6,20	8,23	21,02
30			2,58	3,84	6,86	9,08	25,56
35			4,46	5,98	8,06	9,93	33,52
40			5,50	6,42	9,80	11,50	35,79
45			8,12	8,48	12,47	14,00	39,77
50			9,59	9,96	15,15	18,20	43,18
60				15,42	16,66	23,88	54,54
70					26,42	34,07	67,14
80					35,79	43,87	90,90
90						70,00	158,55
100						93,33	176,63

Prezzo in Euro per 100 pezzi

**ART. 408** VITI A METALLO  
TESTA PIANA SVASATA  
TAGLIO CROCE  
DIN 965 - UNI7688 - ISO7046

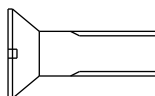

**ART. 410** VITI A METALLO  
TESTA PIANA SVASATA  
CON CALOTTA  
TAGLIO CROCE  
DIN 966 - UNI7689 - ISO7047

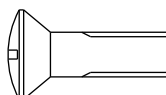

**ART. 411** VITI TESTA TONDA  
QUADRO SOTTO TESTA  
DIN 603 - UNI 5732 - ISO 8677

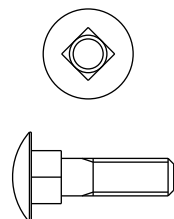

L \ D	M5	M6	M8	M10	M12
16	8,61	13,77	20,66		
20	9,47	14,63	22,38	37,87	
25	10,33	15,49	24,96	41,32	
30	12,05	17,22	27,54	44,76	94,68
35	13,77	18,94	29,27	48,20	99,85
40	15,49	20,66	30,99	51,65	103,29
45	17,22	21,52	32,71	55,09	108,46
50	17,22	22,72	37,87	58,53	113,62
55		24,10	40,46	65,42	118,79
60	25,82	25,13	43,04	68,86	123,95
65		33,57	48,20	80,05	
70		37,87	49,92	82,63	129,11
80		51,65	58,53	94,68	141,16
90		68,86	72,30	120,51	154,94
100		86,08	86,08	129,11	172,15

**ART. 412** VITI TESTA BOMBATA  
ESAGONO INCASSATO  
ISO 7380

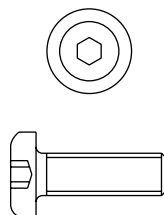

L \ D	M3	M4	M5	M6	M8	M10	M12
6	3,55	3,87					
8	3,07	3,07	4,36	5,97			
10	3,39	3,39	4,68	5,65	13,72		
12	3,71	3,71	4,84	5,97	13,72	25,82	
14	4,03	4,03	5,49	6,46	14,98		
16	4,03	4,03	5,16	6,78	13,40	27,44	
20	4,52	4,52	5,81	7,42	14,04	29,05	
25	4,84	4,84	6,78	8,07	14,85	32,28	54,87
30	7,26	5,81	7,26	9,04	17,75	35,51	59,72
35		8,07	8,07	10,49	20,17	40,35	66,17
40		9,68	8,88	11,62	23,40	42,77	71,01
45				13,56	26,63	45,19	75,85
50			19,37	15,49	29,86	51,65	80,70
60				17,75	37,12	64,56	93,61

NOTA: le zone evidenziate rappresentano la gamma di materiale reperibile presso il produttore

**ART. 413** VITI PER TRUCIOLARE POZY

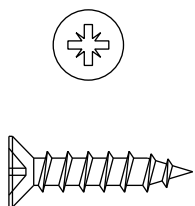

L \ D	M3	M3,5	M4	M4,5	M5	M6
12	1,69	2,10				
16	1,86	2,42	2,74			
20	1,94	2,58	2,91	3,23	4,52	7,26
25	2,42	3,07	3,23	3,87	5,16	8,23
30	3,39	3,55	3,55	4,52	5,97	9,20
35		4,20	4,03	5,33	6,46	10,49
40		5,16	4,52	6,29	7,10	11,78
45			5,65	7,75	8,39	13,56
50			6,62	8,88	9,68	14,53
55					12,59	17,75
60			11,62	11,62	11,62	17,43
70					14,53	21,63
80					17,75	25,82
90					20,17	29,05
100					21,95	32,28

**ART. 414** VITI AUTOFILETTANTI  
TESTA ESAGONALE  
DIN 7976 - UNI 6949 - ISO 1479

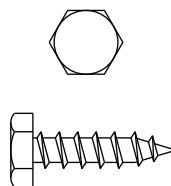

L \ D	M2,9	M3,5	M3,9	M4,2	M4,8	M5,5	M6,3
9,5	3,55	3,55	3,87	4,20	6,94		
13	3,71	3,71	4,20	4,68	7,26	8,23	9,36
16	3,87	3,87	4,36	4,84	7,75	8,72	10,01
19	4,20	4,20	4,68	5,16	8,07	9,04	10,65
22		4,36	5,00	5,65	8,55	9,68	11,14
25		4,68	5,33	5,81	9,04	10,49	11,62
32					8,55	9,68	12,59
38					10,49	10,49	14,04
45						12,10	16,95
50						12,91	17,75
60							22,59
70							29,05

**ART. 415** VITI AUTOFILETTANTI  
TESTA CILINDRICA  
TAGLIO CACCIAVITE  
DIN 7971 - UNI 6951 - ISO 1481

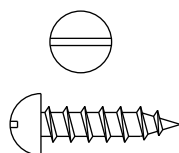

**ART. 416** VITI AUTOFILETTANTI  
TESTA PIANA SVASATA  
TAGLIO CACCIAVITE  
DIN 7972 - UNI 6952 - ISO 1482

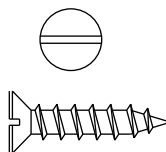

**ART. 417** VITI AUTOFILETTANTI  
TESTA PIANA SVASATA  
CON CALOTTA  
TAGLIO CACCIAVITE  
DIN 7973 - UNI 6953 - ISO 1483

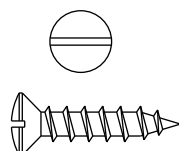

L \ D		N.3	N.4	N.6	N.7	N.8	N.10	N.12	N.14
Inch	mm	2,2	2,9	3,5	3,9	4,2	4,8	5,5	6,3
1/4"	6,5	2,14	1,35	1,85	2,03				
3/8"	9,5	2,14	1,35	1,85	2,07	2,28	3,53		
1/2"	13	2,32	1,42	1,89	2,14	2,42	3,53	5,31	6,13
5/8"	16	2,32	1,57	1,96	2,28	2,67	3,92	5,66	6,59
3/4"	19		1,78	2,17	2,67	2,96	4,24	6,06	7,62
7/8"	22		2,14	2,53	2,99	3,24	4,67	6,91	8,30
1"	25		2,46	3,13	3,13	3,35	4,88	7,52	9,19
1 1/4"	32			3,45	4,20	4,42	5,49	8,80	10,69
1 1/2"	38			4,06	4,49	5,31	6,66	9,62	11,83
1 3/4"	45						6,87	9,08	12,93
2"	50						8,30	10,04	14,25
2 3/8"	60							14,67	15,96
2 1/2"	70							19,84	21,66
3 1/16"	80							25,86	28,89

Prezzo in Euro per 100 pezzi

**ART. 418** VITI AUTOFILETTANTI  
TESTA CILINDRICA  
TAGLIO CROCE  
DIN 7981 - UNI 6954 - ISO 7049

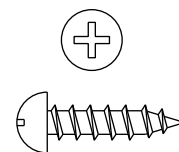

**ART. 419** VITI AUTOFILETTANTI  
TESTA PIANA SVASATA  
TAGLIO CROCE  
DIN 7982 - UNI 6955 - ISO 7050

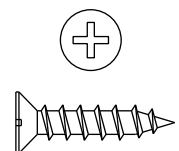

**ART. 420** VITI AUTOFILETTANTI  
TESTA PIANA SVASATA  
CON CALOTTA  
TAGLIO CROCE  
DIN 7983 - UNI 6956 - ISO 7051

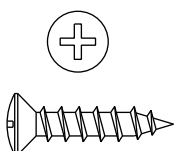

L \ D		N.3	N.4	N.6	N.7	N.8	N.10	N.12	N.14
Inch	mm	2,2	2,9	3,5	3,9	4,2	4,8	5,5	6,3
1/4"	6,5	1,96	1,25	1,50	1,88	2,24			
3/8"	9,5	1,96	1,25	1,50	1,88	2,06	3,37		
1/2"	13	2,14	1,37	1,64	2,04	2,24	3,37	5,29	6,39
5/8"	16	2,14	1,49	1,71	2,19	2,51	3,74	5,64	6,88
3/4"	19		1,68	1,92	2,63	2,77	4,04	6,03	7,95
7/8"	22		2,04	2,21	2,90	2,99	4,45	6,90	8,64
1"	25		2,23	2,78	3,06	3,18	4,64	7,48	9,58
1 1/4"	32		4,54	3,13	4,19	4,19	5,24	8,78	11,14
1 1/2"	38			3,67	4,47	5,05	6,36	9,60	12,33
1 3/4"	45			8,26	7,75	6,54	8,64	12,93	15,61
2"	50			9,30	8,26	7,89	9,57	14,22	17,57
2 3/8"	60						15,49	13,99	15,95
2 1/2"	70						22,72	18,92	21,63
3 1/16"	80							24,68	28,88

Prezzo in Euro per 100 pezzi

NOTA: le zone evidenziate rappresentano la gamma di materiale reperibile presso il produttore

**ART. 421** DADI ESAGONALI ALTI  
UNI 5587

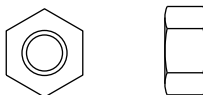

Ø	UNI 5587			UNI5588 DIN 934			Autoblok	
	Ch	H		Ch	H		DIN982	DIN985
M2			9,68	4	1,6	2,00		
M2,5			8,07	5	2	1,97		
M3	5,5	3	2,73	5,5	2,4	1,43	15,51	4,09
M4	7	4	2,79	7	3,2	1,65	6,23	3,84
M5	8	5	3,66	8	4	1,97	5,83	4,01
M6	10	6	4,66	10	5	2,89	7,10	4,41
M8	13	8	9,05	13	6,5	5,97	13,50	9,02
M10	17	10	19,69	17	8	13,26	28,12	19,88
M12	19	12	28,31	19	10	19,24	42,41	29,83
M14	22	14	55,26	22	11	29,09	102,97	56,01
M16	24	16	67,48	24	13	37,28	107,66	67,74
M18	27	18	181,09	27	15	61,12	403,44	379,48
M20	30	20	149,13	30	16	74,57	432,73	383,47
M22	32	22	351,52	32	18	106,92	798,91	672,43
M24	36	24	409,43	36	19	166,44	918,73	859,07
M27	41	27	909,43	41	22	669,74	1917,35	1258,86

**ART. 422** DADI ESAGONALI MEDI  
DIN 934 - UNI 5588



**ART. 423** DADI AUTOBLOK  
DIN 982 - DIN 985



Prezzo in Euro per 100 pezzi

**ART. 424** BARRA FILETTATA  
DIN 975

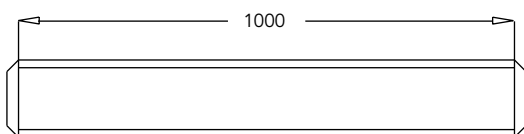

Ø	€/Metro	Ø	€/Metro	Ø	€/Metro
M2		M10	4,96	M24	35,53
M2,5		M12	7,54	M27	47,15
M3	1,55	M14	9,97	M30	58,41
M4	1,55	M16	13,12	M33	87,18
M5	1,70	M18	16,78	M36	110,42
M6	1,76	M20	20,76	M39	154,94
M8	3,20	M22	26,80	M42	

**ART. 425** DADI CIECHI A CALOTTA  
DIN 1587 - UNI 5721

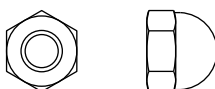

**ART. 426** DADI AD ALETTE  
DIN 315 - UNI 5448

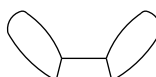

**ART. 427** RONDELLE PIANE  
GREMBIALINA  
DIN 9021

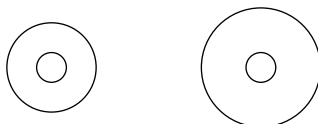

3 VOLTE IL FORO

4 VOLTE IL FORO

Ø	Ciechi		Rondelle Piane Grembialina			
	Din 1587	Aletta Din 315	3 volte il foro		4 volte il foro	
M3	29,20	29,05	3x9x0,8	0,95	3x12x0,8	2,00
M4	21,16	29,05	4x12x1	1,47	4x16x1	3,36
M5	19,74	29,05	5x15x1,2	2,30	5x20x1,5	5,99
M6	21,59	29,05	6x18x1,5	3,06	6x24x1,6	10,12
M8	40,34	52,29	8x24x2	7,32	8x32x2	17,31
M10	70,87	77,47	10x30x2	13,05	10x40x2	39,94
M12	112,06	174,30	12x36x2,5	26,63	12x48x2,5	63,91
M14	312,46	367,98	14x42x2,5	43,27	14x56x3	112,91
M16	333,76	367,98	16x42x2,5	63,91	16x64x4	146,46
M18	607,82	619,75	18x54x3	161,39		
M20	744,32	619,75	20x60x3	209,81	20x80x4	403,48
M22	1096,49					
M24	1211,66					

Prezzo in Euro per 100 pezzi

**ART. 428** RONDELLE PIANE (RP)  
UNI 6592 - DIN 125



**ART. 429** RONDELLE GROWER (RG)  
UNI 1751 - DIN 127



**ART. 430** RONDELLE DENTELLATE (RD)  
DIN 6798

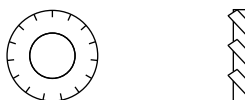

Ø	RP	RG	RD
M2	0,61	0,69	1,45
M2,5	0,51	0,69	1,45
M3	0,51	0,67	1,06
M4	0,67	0,72	1,31
M5	0,84	0,97	1,47
M6	1,53	1,61	2,13
M8	2,45	2,56	3,36
M10	4,47	3,84	5,99
M12	7,59	6,45	7,60
M14	12,08	10,31	11,48
M16	14,38	14,27	14,65
M18	21,30	17,95	27,70
M20	22,77	24,51	33,88
M22	28,49	28,92	45,19
M24	55,12	46,97	54,87
M27	72,43	50,14	72,63
M30	83,88	125,71	80,70
M33	121,05	290,51	
M36	153,33	322,79	
M39	216,27		

Prezzo in Euro per 100 pezzi

**ART. 431 RIVETTI A STRAPPO LEGA INOX**

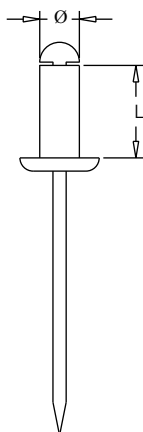

CONFEZIONI DA 1000 PEZZI

= NORME DIN 7337

Corpo		Inox	Inox	Corpo		Inox	Inox
Mandrino	Alluminio	Inox	Mandrino	Alluminio	Inox	Inox	
Ø	L	Rivetti ermetici	Ø	L	Rivetti ermetici		
3,0	6			6		39,80	70,20
	8			8		42,00	74,80
	10			9,5		108,40	118,80
	12			10		45,70	79,60
3,2	6			11		42,00	124,00
	7,5			12		87,80	128,00
	8			14		44,20	95,50
	9,5			16		93,00	112,10
	10			8		50,70	102,70
3,8	12			8,5		67,30	134,30
	7			10			112,80
	9			11,5			147,20
	11			12			123,70
	14			14			135,30
	16			14,5			160,10
				16			151,90
				18			170,40
						162,70	

**ART. 432 COPIGLIE AISI 304 - UNI 1336 - DIN 94 - ISO 1234**

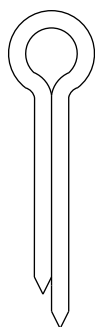

L \ D	M1	M1,5	M2	M2,5	M3	M3,5	M4	M4,5	M5	M6	M8	M10
10	0,81	1,68	2,16	3,66								
12	0,81	1,68	2,16	3,66								
15	0,81	1,68	2,16	3,66	5,44							
20	0,87	1,79	2,68	4,47	6,46	9,31	12,72	16,53				
25	1,03	2,07	3,18	5,28	7,59	10,76	13,80	18,03				
30	1,24	2,47	3,91	6,41	9,07	12,85	16,20	21,27	24,27			
35	1,37	2,70	4,31	7,05	9,94	14,04	17,61	23,14	26,57	44,96		
40		2,91	4,71	7,68	10,76	14,96	19,00	25,00	28,81	48,29		
45			5,23	8,51	11,88	16,40	20,72	27,31	31,68	52,50		
50				9,30	12,96	17,90	22,48	29,62	34,54	56,68	100,81	165,44
60					15,75	21,71	26,98	35,65	41,96	67,62	119,40	194,78
70							29,73	39,41	46,50	74,18	131,02	212,80
80										81,84	143,95	233,13
90										90,25	158,18	255,65
100										98,64	172,56	278,16
110											183,85	305,32
120											201,32	323,33

Prezzo in Euro per 100 pezzi

**ART. 433 GRANI A CAVA ESAGONALE UNI 5923 - DIN 913 - ISO 4026**

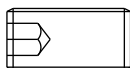

**ART. 434 GRANI A CAVA ESAGONALE CON PUNTA ESTERNA UNI 5927 - DIN 914 - ISO 4027**

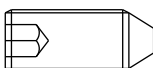

**ART. 435 GRANI A CAVA ESAGONALE CON PUNTA INTERNA UNI 5929 - DIN 916 - ISO 4029**

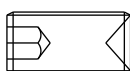

L \ D	M2	M2,5	M3	M4	M5	M6	M8	M10	M12	M14	M16	M20	
3	18,22	18,22	7,23										
4	18,44	15,29	5,82	5,87									
5	18,65	15,40	5,29	5,11	5,99								
6	18,87	15,51	5,40	5,29	5,58	6,46							
8	19,41	15,62	5,64	5,64	5,87	7,23	11,28						
10	20,17	18,87	6,11	5,87	6,34	7,64	11,28	20,80					
12	45,55	20,82	6,81	6,70	6,81	8,05	13,04	19,74	31,72				
14			12,16	10,57	8,11	9,46	13,51	23,97	37,36				
16			12,16	10,57	8,11	9,46	13,51	23,97	37,36	123,64	131,45		
20			16,39	14,28	9,87	11,28	16,92	26,79	43,00	124,94	149,67	648,57	
25				20,98	15,51	16,92	21,15	31,55	50,76	143,16	169,19	687,61	
30				29,05	19,03	21,15	23,79	35,95	58,51	160,08	192,62	727,74	
35				40,35	21,85	23,97	26,79	45,12	67,68	178,30	218,65	766,78	
40				43,58	23,97	25,73	29,26	46,53	74,73	197,82	239,47	805,83	
45					58,10	38,73	37,36	58,51	81,78	227,76	277,21	871,99	
50					61,33	40,35	38,77	59,92	97,99	244,68	299,34	885,00	
60						50,03	64,56	100,06	145,25	282,42	354,00	950,07	
70									145,25	169,46	324,07	415,17	1020,57
80									161,39	201,74	402,15	498,46	1092,15
90									177,53	225,95	488,05	598,68	1163,73
100									209,81	258,23	507,57	620,80	1279,78

Prezzo in Euro per 100 pezzi

**ART. 436** SPINE CILINDRICHE  
UNI 1707 - DIN 7

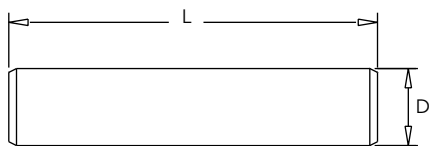

L \ D	1	1,5	2	2,5	3	4	5	6	8	10	12
6											
8											
10											
12											
16											
20											
25											
30											
35											
40											
50											
60											
70											
80											

NOTA: le zone evidenziate rappresentano la gamma di materiale reperibile presso il produttore

**ART. 437** SEEGER ESTERNI  
UNI 7435 - DIN 471  
(da M4 a M100)



**ART. 439** ANELLI RADIALI TIPO RS BENZING  
DIN 6799

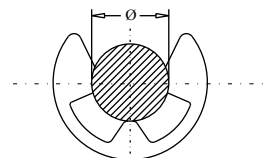

**ART. 438** SEEGER INTERNI  
UNI 7437 - DIN 472  
(da M8 a M100)



**ART. 440** DADI ESAGONALI A SALDARE  
DIN 929



**ART. 441** VITI A LEGNO TESTA ESAGONALE  
DIN 571 UNI 704

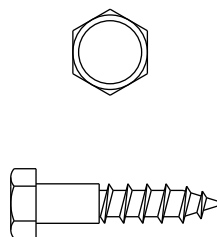

L \ D	M5	M6	M8	M10	M12
30	17,75	14,53			
35	19,37	16,14	25,82		
40	20,98	17,75	27,44	54,87	
45	24,21	19,37	29,05	56,49	
50	25,82	20,98	30,66	58,10	96,84
60	29,05	23,40	35,51	64,56	106,52
70		26,63	40,35	69,40	122,66
80		30,66	46,00	74,24	135,57
90		33,89	51,65	83,92	151,71
100		37,12	58,10	90,38	161,39
110		56,49	88,77	112,97	201,42
120		67,14	96,84	121,04	211,42

Prezzo in Euro per 100 pezzi

**ART. 444** DADI A STRAPPO (ANTIRAPINA)

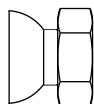
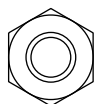

Viti
M6
M8
M10

**ART. 450** INSERTI FILETTATI  
A TESTA CILINDRICA  
DIN 7976

